

## OTTOMAN & BENCH SERIES

# CRESCENT OTTOMAN

Product No. F003

The crescent shape of this ottoman is a conversation starter. If you're looking for a simple way to add extra seating and character to a room without sacrificing design, this is a piece you can't ignore. Relax into it as a footstool or a seat.



Shown with 1" Nylon Glides

## DETAILS

### CONSTRUCTION

- Solid foam construction
- Reinforced seams and stitching
- Wood base to fit foot options
- Made in USA
- Backed with a lifetime warranty

### MODIFICATION

- Seat height
- Textile and placement
- Foot and finish options
- Fully zippered (no wood base)
- Stitching and zipper colors
- HPL work surface
- Embroidery

**WEATHER RESISTANT**  
See series page for more details. »



## QUICK COMBOS

F052, F053, F051, F003

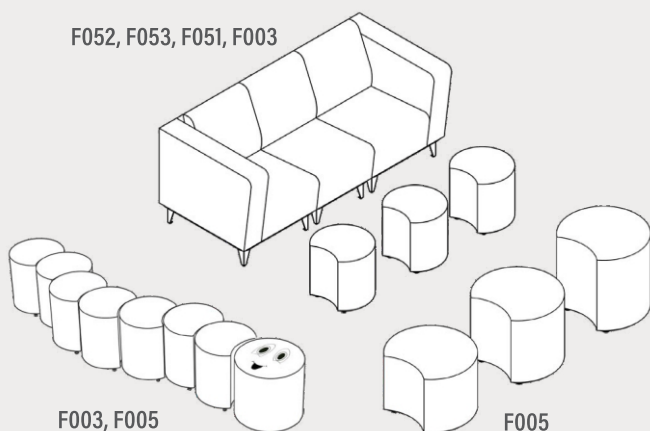

## HOW TO SPECIFY F003

### STEP 1: SEAT HEIGHT

DIMENSION (DIA)	SEAT HEIGHT
 18"	12"
	14"
	16"
	18"
	20"

### STEP 2: FOOT AND FULLY ZIPPERED

#### FULLY ZIPPERED



Fully Zippered (Z)

#### 1" STANDARD FOOT OPTIONS



Nylon Glide (G1)



Felt Glide (G1)



1" Low Profile Leg (L1)  
Black

\*Reference the product breakdown on back for availability.

#### 3" PREMIUM FOOT OPTIONS



3" Rectangle (R3)  
Black



3" Rectangle (R3)  
Silver

#### 6" PREMIUM FOOT OPTIONS



6" Mod Leg (M6)



6" Rectangle (R6)  
Black



6" Rectangle (R6)  
Silver

### STEP 3: GRADE AND TEXTILE

#### GRADES & SWATCHES



[CLICK TO VIEW »](#)

#### FABRIC DIRECTION & COLOR GUIDE



[CLICK TO VIEW »](#)

\*Thread will default to match the seat textile.

#### COLOR GUIDE

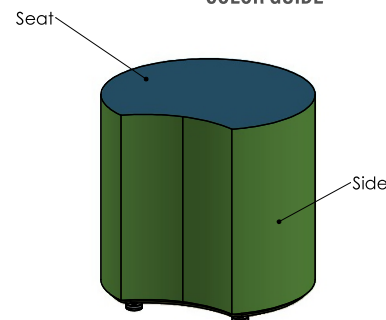

### STEP 4: MODIFICATIONS (OPTIONAL)

#### HPL WORKSURFACE (HPL)



**Black Matte**  
**Black Gloss - Writable Surface**

EDGE-BANDING OPTIONS



Black Matte/Gloss  
Spectrum Red



Chrome Yellow  
Orange Grove



Spectrum Blue



**Dover White Matte**  
**Dover White Gloss - Writable Surface**

EDGE-BANDING OPTIONS



White Matte/Gloss  
Black Matte/Gloss  
Spectrum Red



Chrome Yellow  
Orange Grove



Spectrum Blue  
Navy Blue



**Gull Grey**  
w/ matching  
edgebanding



**Chelsea Maple**  
w/ matching  
edgebanding



**Black Riftwood**  
w/ matching  
edgebanding



**White Twill**  
w/ matching  
edgebanding