



education **environments**
flexible. functional. engaging.

OTTOMAN & BENCH SERIES

ROK DROP

Product No. F166

Our ROK Drop active seating solution is sure to be a hit with your active learners. Solid foam, single-cut construction guarantees that learners will be comfortable, safe, and free to move. The rounded base allows energized students to satisfy their urge to move without distracting their peers. The result is a more comfortable, attentive, and ready to learn student.



DETAILS

CONSTRUCTION

- Solid foam construction
- Reinforced seams and stitching
- Non-slip base
- Made in USA
- Backed with a lifetime warranty

MODIFICATION

- Seat height
- Textile and placement
- Colored stitching
- Embroidery



HOW TO SPECIFY F166

STEP 1: SEAT HEIGHT

DIMENSION (DIA x H)	SEAT DIAMETER
 14" x 14"	13"

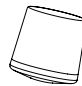
DIMENSION (DIA x H)	SEAT DIAMETER
 18" x 18"	16"

STEP 2: FULLY ZIPPERED

FULLY ZIPPERED



Fully Zippered (Z)

**Reference the product breakdown on back for availability.*

STEP 3: GRADE AND TEXTILE

GRADES & SWATCHES



[CLICK TO VIEW »](#)

FABRIC DIRECTION & COLOR GUIDE



[CLICK TO VIEW »](#)

**Thread will default to match the seat textile.*

COLOR GUIDE

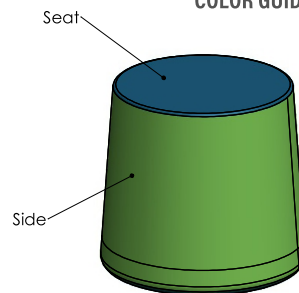

STEP 4: ACCESSORIES (OPTIONAL)

EMBROIDERY

- Personalize your furniture with embroidery!
- We can embroider logos up to 12" x 15".

EMBROIDERY SPECS

[CLICK TO VIEW »](#)



CAL TB-133

- Optional flame retardant add on.

**Reference the product breakdown on back for availability.*