

# OTTOMAN & BENCH SERIES ROK DROP

Product No. F166

Our ROK Drop active seating solution is sure to be a hit with your active learners. Solid foam, single-cut construction guarantees that learners will be comfortable, safe, and free to move. The rounded base allows energized students to satisfy their urge to move without distracting their peers. The result is a more comfortable, attentive, and ready to learn student.



## DETAILS

### CONSTRUCTION

- Solid foam construction
- Reinforced seams and stitching
- Non-slip base
- Made in USA
- Backed with a lifetime warranty

### MODIFICATION

- Seat height
- Textile and placement
- Colored stitching
- Embroidery



## HOW TO SPECIFY F166

### STEP 1: SEAT HEIGHT

DIMENSION (DIA x H)	SEAT DIAMETER
 14" x 14"	13"

DIMENSION (DIA x H)	SEAT DIAMETER
 18" x 18"	16"

### STEP 2: FULLY ZIPPERED

#### FULLY ZIPPERED



*\*Reference the product breakdown on back for availability.*

### STEP 3: GRADE AND TEXTILE

#### GRADES & SWATCHES



[CLICK TO VIEW »](#)

#### FABRIC DIRECTION & COLOR GUIDE



[CLICK TO VIEW »](#)

#### COLOR GUIDE

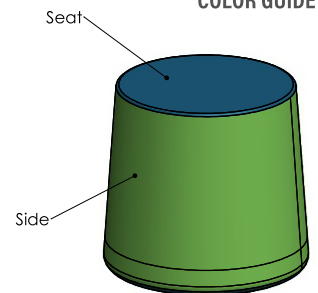

*\*Thread will default to match the seat textile.*

### STEP 4: ACCESSORIES (OPTIONAL)

#### EMBROIDERY

- Personalize your furniture with embroidery!
- We can embroider logos up to 12" x 15".

#### EMBROIDERY SPECS

[CLICK TO VIEW »](#)



#### CAL TB-133

- Optional flame retardant add on.

*\*Reference the product breakdown on back for availability.*